

BLUE'S DECOR

dekoratif dış cephe çözümleri

catalogue



DIŐ CEPHENİZİ TECRÜBELİ ELLERE EMANET EDİN

BLUE'S Decor ürünleri, 1998 yılından bu yana Mardav tarafından sektöre sunulmaktadır. 10 yılı aşkın tecrübemizle piyasaya sunulan BLUE'S Decor ürünleri Türkiye'nin birçok yerinde prestijli konutların cephelerine değer katmaktadır.

Üretim teknolojisinin getirdiđi avantajlar sayesinde; özel tasarımlar hızlı, pratik ve ekonomik olarak kullanıcıların hizmetine sunulmaktadır.



XPS malzemelerinin mucidi ve dünya pazar lideri Dow Bina Çözümleri, 44 ülkede 30'u aşan üretim tesisiyle faaliyet gösteren bir dünya şirkettir. Gebze Dilovası Tesisleri'nde üretilmekte olan STYROFOAM™ ürünleri ile yalıtım sektöründe öncü ve lider konumunu sürdürmektedir.



Uzman bayi ađı, teknik, satış ve pazarlama kadrosu ile yalıtım sektörünün öncü ve lider firmalarından olan Mardav; Dow Bina Çözümleri ve Ravago S.A. firmalarının ortaklığında faaliyet gösteren bir pazarlama firmasıdır.



Kale Grubu Şirketlerinin kurucusu Sn. Dr. İbrahim Bodur tarafından 1973 yılında Kalekim A.Ş. seramik yapıştırıcıları ve derz dolguları üretimiyle başladığı faaliyetlerine bugün inşaat sektörünün en önemli ihtiyaçlarından olan, yapı kimyasallarını üreterek devam etmektedir.



DIŐ CEPHE MODASINI BLUE'S DECOR BELİRLİYOR

BLUE'S DECOR ;

Eski veya yeni her türlü yapıda kullanılabilen çekirdek malzemesi su veya mekanik etkilere dayanıklı STYROFOAM™ olan üzeri akrilik veya çimento bazlı endüstriyel sıva kaplı dekoratif dış cephe elemanlarıdır.

TECRÜBE

1998 yılından bu yana Türkiye'nin birçok yerinde prestijli yapıların cephelerini süslemektedir.

ESTETİK

Standart modellerin dışında yaratıcılığa imkan veren sınırsız tasarım imkanı.

YARATICILIK

Kolay işlenebilirlik ve teknoloji sayesinde yaratıcı çizimlerin hayata dönüşmesi.

EKONOMİK

Prekast ve taş yapı elemanlarına göre ekonomiktir. İşçilik ve zamandan tasarruf sağlar.

HAFİFLİK

Standart (4x15)cm Blues Decor söve betondan yapılan muadilinden 10 kat daha hafiftir.
Boyutlar büyüdükçe bu oranda yükselmektedir.



FİHRİST :

SÖVELER.....	2-5
SİLME ve SAÇAK	
PROFİLLERİ.....	6-8
DENİZLİK PROFİLLERİ.....	9-10
DİZAYN SERİSİ SİLMELER.....	11-12
KÖŞE PROFİLLERİ.....	13
KİLİT TAŞLARI.....	14-15
PAYANDALAR.....	16
HARPUŞTALAR.....	17
SÜTUN ve KAİDELER.....	18-19
CEPHE KAPLAMALARI.....	20-22
PENCERE SETLERİ.....	23-25
KONSEPT TASARIMLAR.....	26-28
SİSTEM VE UYGULAMA DETAYLARI.....	29

SÖVELER



sv 10-01



sv 10-02



sv 10-03



sv 10-04



sv 10-05



sv 10-06

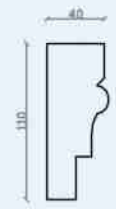

sv 10-07



sv 10-08



sv 10-09

Ölçü birimi mm'dir.
x = 30 veya 40 ebatında üretilebilir.



dis cephenizin mimari siz olun...

SÖVELER



sv 10 - 10



sv 10 - 11



sv 10 - 12

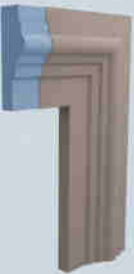

sv 10 - 13



sv 10 - 14



sv 10 - 15



sv 10 - 16



sv 10 - 17

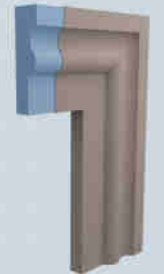

sv 10 - 18

Ölçü birimi "mm" dir
x = 30 veya 40 mm ebatında üretilebilir



BLUE'S DECOR



sv 10 - 19

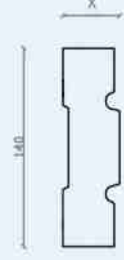

sv 10 - 20

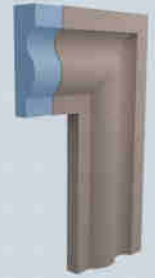

sv 10 - 21

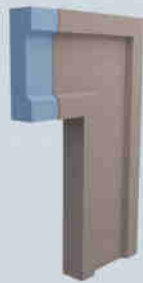
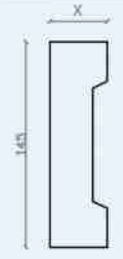

sv 10 - 22

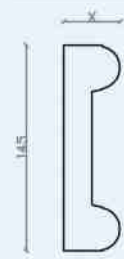

sv 10 - 23

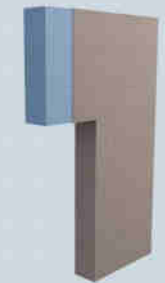

sv 15 - 01

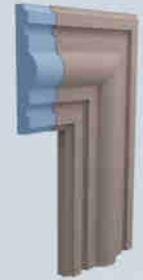
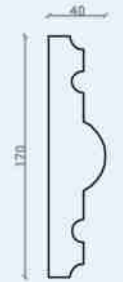

sv 15 - 02

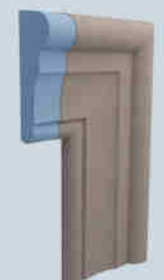

sv 15 - 03



sv 15 - 04

Ölçü birimi "mm"dir.

x = 30 veya 40 ebatında üretilebilir.



dış cephede yeni trendler...

SÖVELER

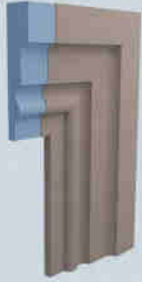

sv 15-05



sv 15-06



sv 15-07

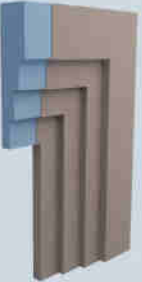
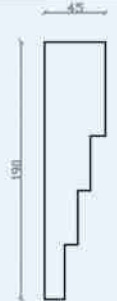

sv 15-08

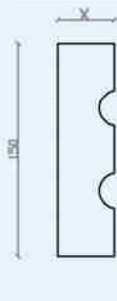

sv 15-09

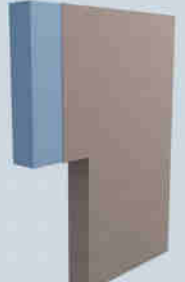

sv 20-01

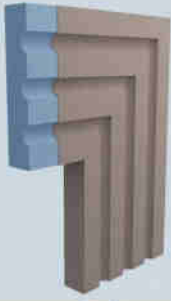
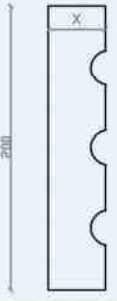

sv 20-02



sv 20-03

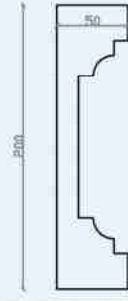

sv 20-04

Ölçü birimi "mm"dir.
x = 30 veya 40 ebatında üretilebilir



SİLME VE SAÇAK PROFİLLERİ



ks 15-01

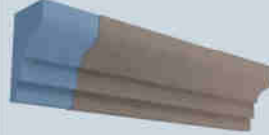
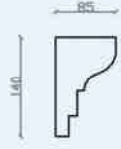

ks 15-02

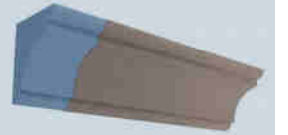
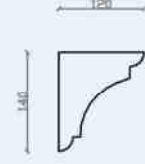

ks 15-03

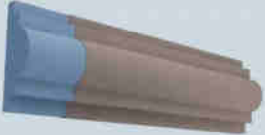
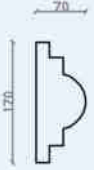

ks 15-04

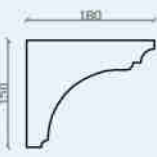

ks 15-05

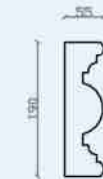

ks 15-06

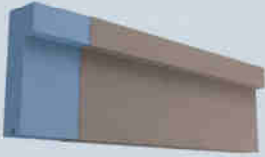

ks 15-07

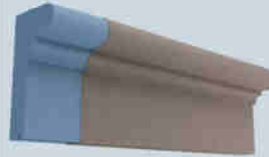
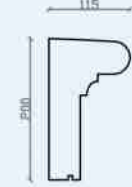

ks 20-01

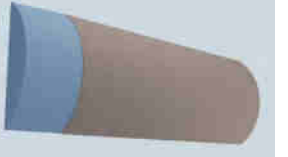

ks 20-02

Ölçü birimi "mm"dir.



dış cephenize yaratıcı dokunuş...

SİLME VE SAÇAK PROFİLLERİ



ks 20-03

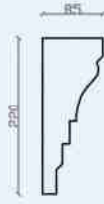

ks 20-04

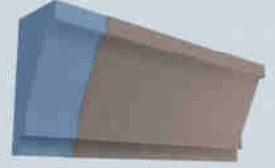

ks 20-05

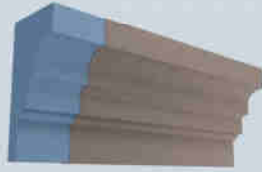

ks 20-06

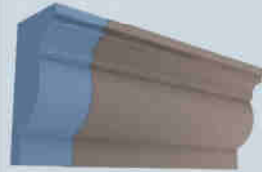
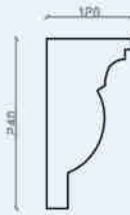

ks 20-07



ks 25-01

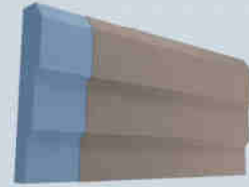

ks 25-02

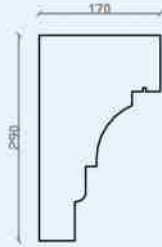

ks 25-03



ks 30-01

Ölçü birimi "mm"dir.



BLUE'S DECOR

SİLME VE SAÇAK PROFİLLERİ

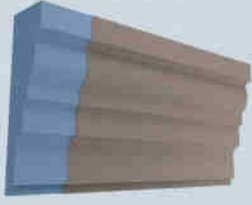

ks30-02

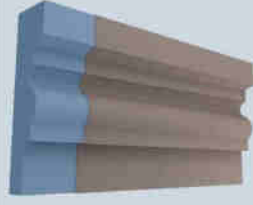
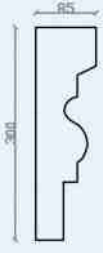

ks30-03

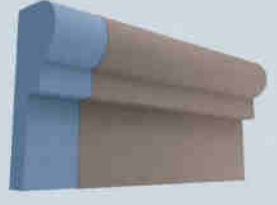
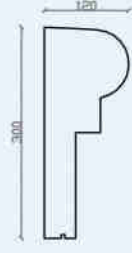

ks30-04

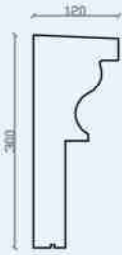

ks30-05

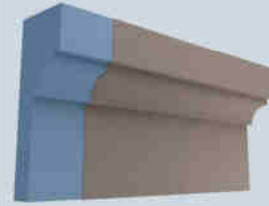

ks30-06

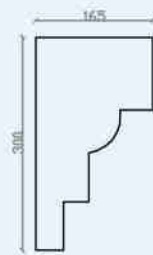

ks30-07

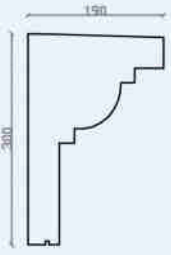

ks30-08

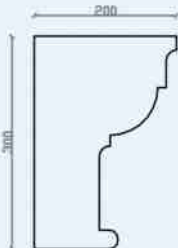

ks30-09



ks30-10

Ölçü birimi "mm" dir.



dış cepheniz güvenli ellerde...

DENİZLİK PROFİLLERİ



dp 10-01

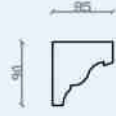

dp 10-02

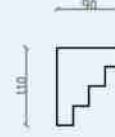

dp 10-03

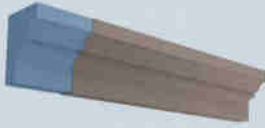

dp 10-04

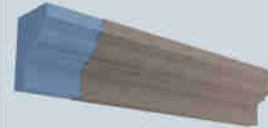
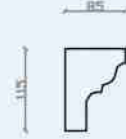

dp 10-05

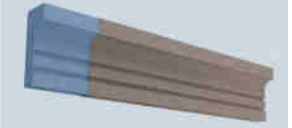
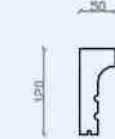

dp 10-06

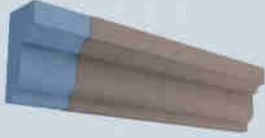
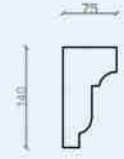

dp 10-07

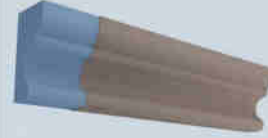

dp 10-08

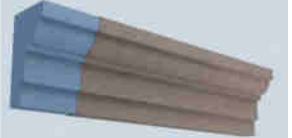

dp 10-09

Ölçü birimi "mm"dir.



BLUE'S DECOR

DENİZLİK PROFİLLERİ



dp 15-01

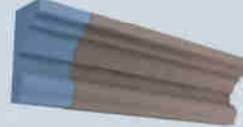
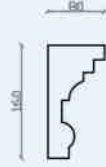

dp 15-02

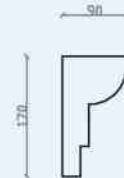

dp 15-03

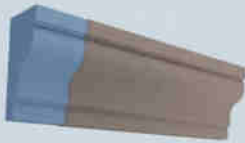
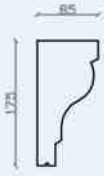

dp 15-04

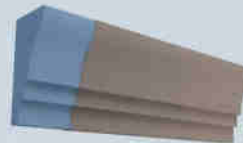

dp 15-05

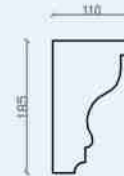

dp 15-06



dp 15-07

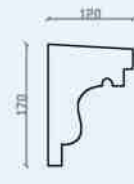

dp 15-08

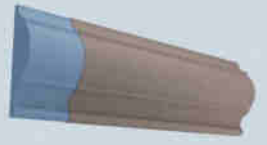

dp 15-09

Ölçü birimi "mm"dir.

kendi dış cephenizi yaratın.

DİZAYN SERİSİ



ds 15-01

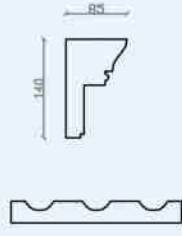

ds 15-02



ds 15-03

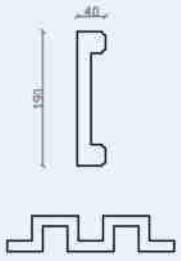

ds 15-04

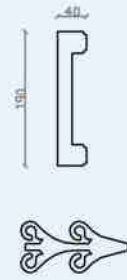

ds 15-05

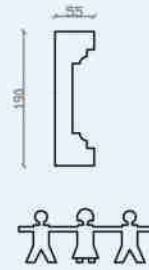

ds 15-06

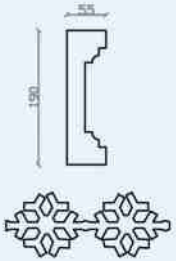

ds 15-07

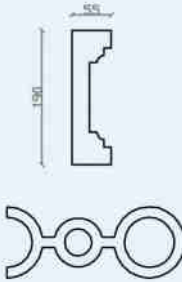

ds 15-08

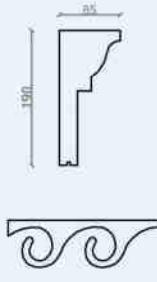

ds 15-09

Ölçü birimi "mm"dir.

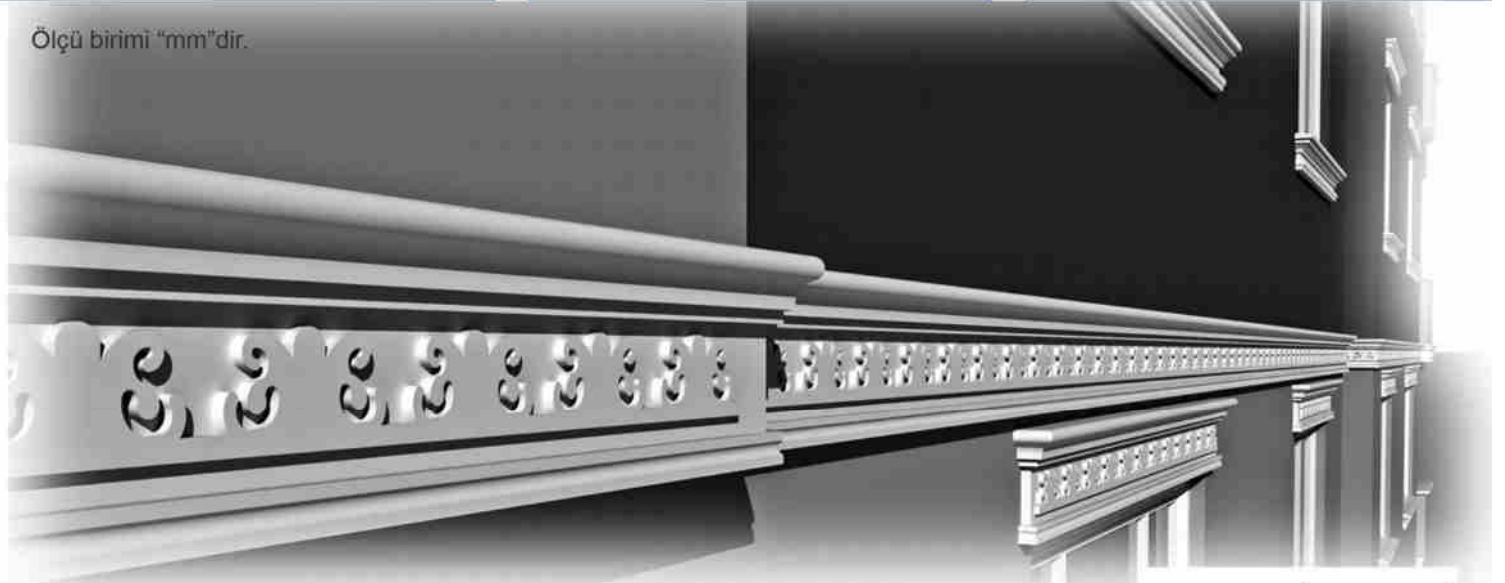

BLUE'S DECOR

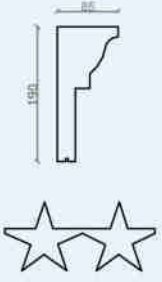

ds 15 - 10

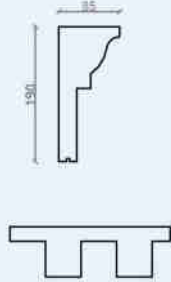

ds 15 - 11



ds 15 - 12

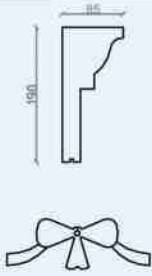

ds 15 - 13

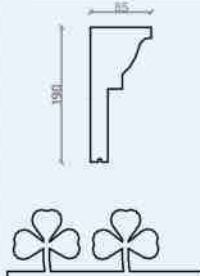

ds 15 - 14

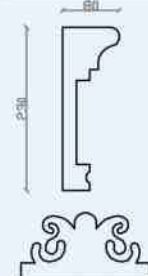

ds 20 - 01

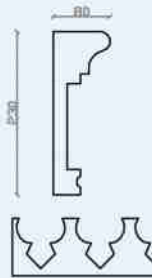

ds 20 - 02

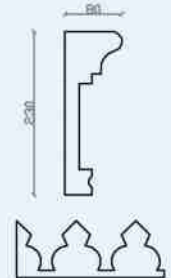

ds 20 - 03

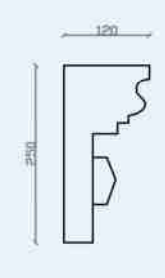

ds 20 - 04

Ölçü birimi "mm"dir.

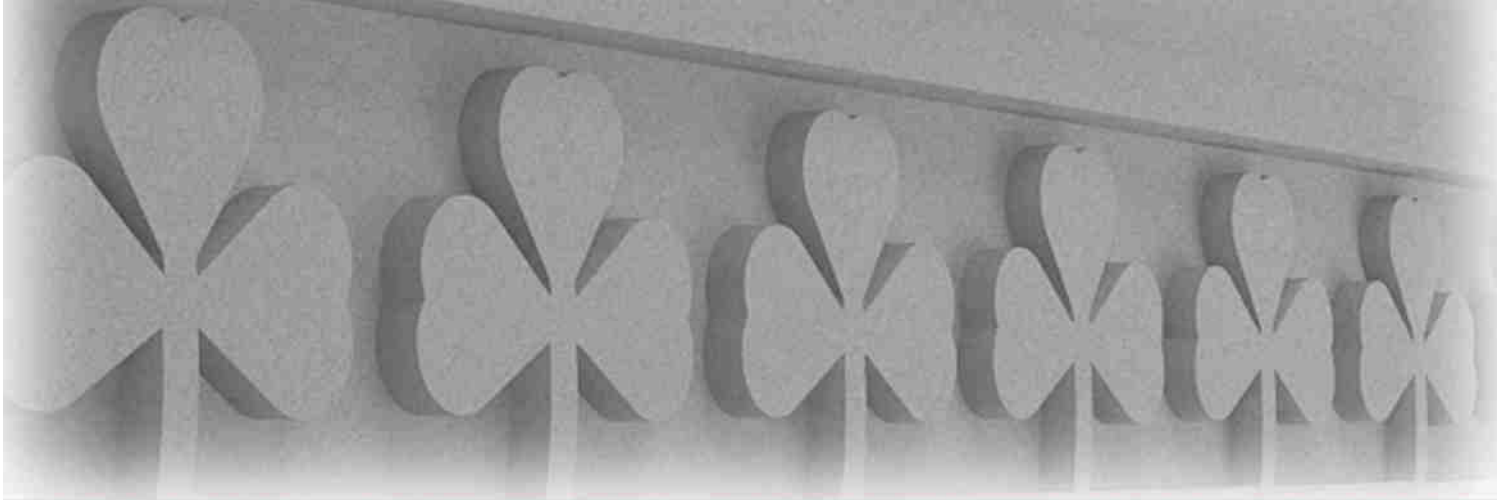

dış cephenizin mimarı siz olun...

KÖŞE PROFİLLERİ

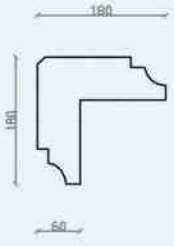

kp 20-01

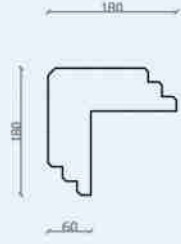

kp 20-02

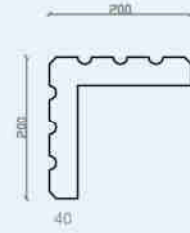

kp 20-03

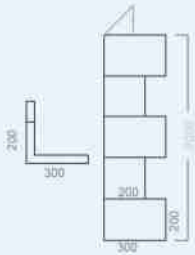

kp 20-04

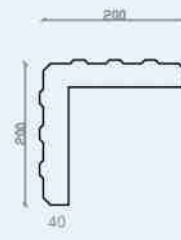

kp 20-05

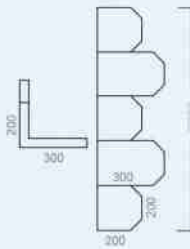

kp 20-06

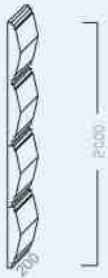

kp 20-07



kp 20-08

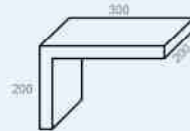

kp 20-09

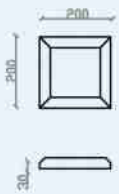

kp 20-10

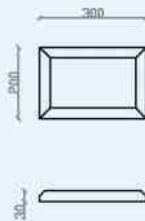

kp 20-11

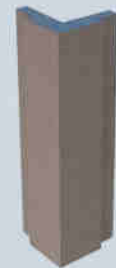
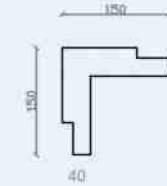

kp 15-01

Ölçü birimi "mm" dir.



BLUE'S DECOR

KİLİT TAŞLARI



kt-01



kt-02



kt-03



kt-04



kt-05

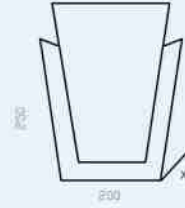

kt-06



kt-07



kt-08



kt-09

Ölçü birimi "mm" dir.

x= 30-40-50- 60 mm ebatında üretilebilir.

* KT ürünlerinin değişken kalınlıkları fiyat listesinde mevcuttur.

dış cephenizin mimarı siz olun...

KİLİT TAŞLARI

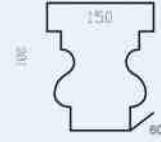
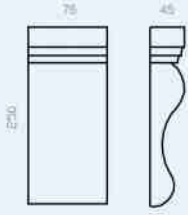
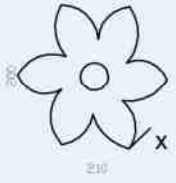

kt - 10

kt - 11

kt - 12

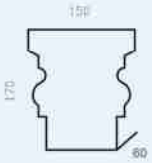

kt - 13

kt - 14

kt - 15



kt - 16

kt - 17

kt - 18

Ölçü birimi "mm" dir.
x= 30-40-50-60 mm ebatında üretilebilir.



BLUE'S DECOR

PAYANDALAR



py - 0 1

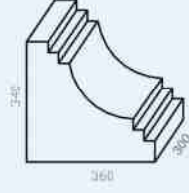

py - 0 2



py - 0 3



py - 0 4



py - 0 5



py - 0 6

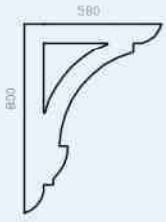

py - 0 7



py - 0 8



py - 0 9



py - 1 0



py - 1 1



py - 1 2

Ölçü birimi "mm" dir. Payandaların değişken kalınlıkları fiyat listesinde mevcuttur.

sihirli bir dokunuş...

HARPUŞTALAR

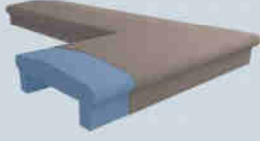
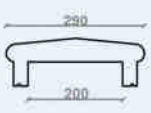

hp-01

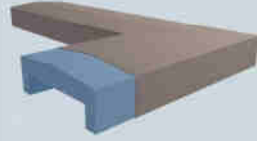
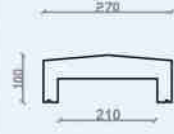

hp-02

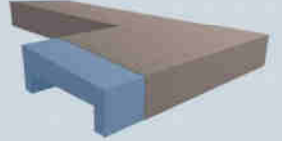
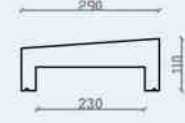

hp-03

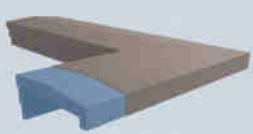
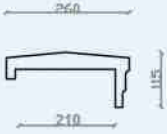

hp-04

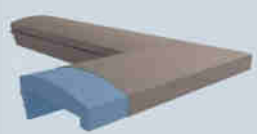
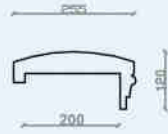

hp-05

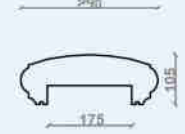

hp-06

Ölçü birimi "mm" dir.

* Uygulanacak yere göre ölçülerde değişiklik yapılabilir.

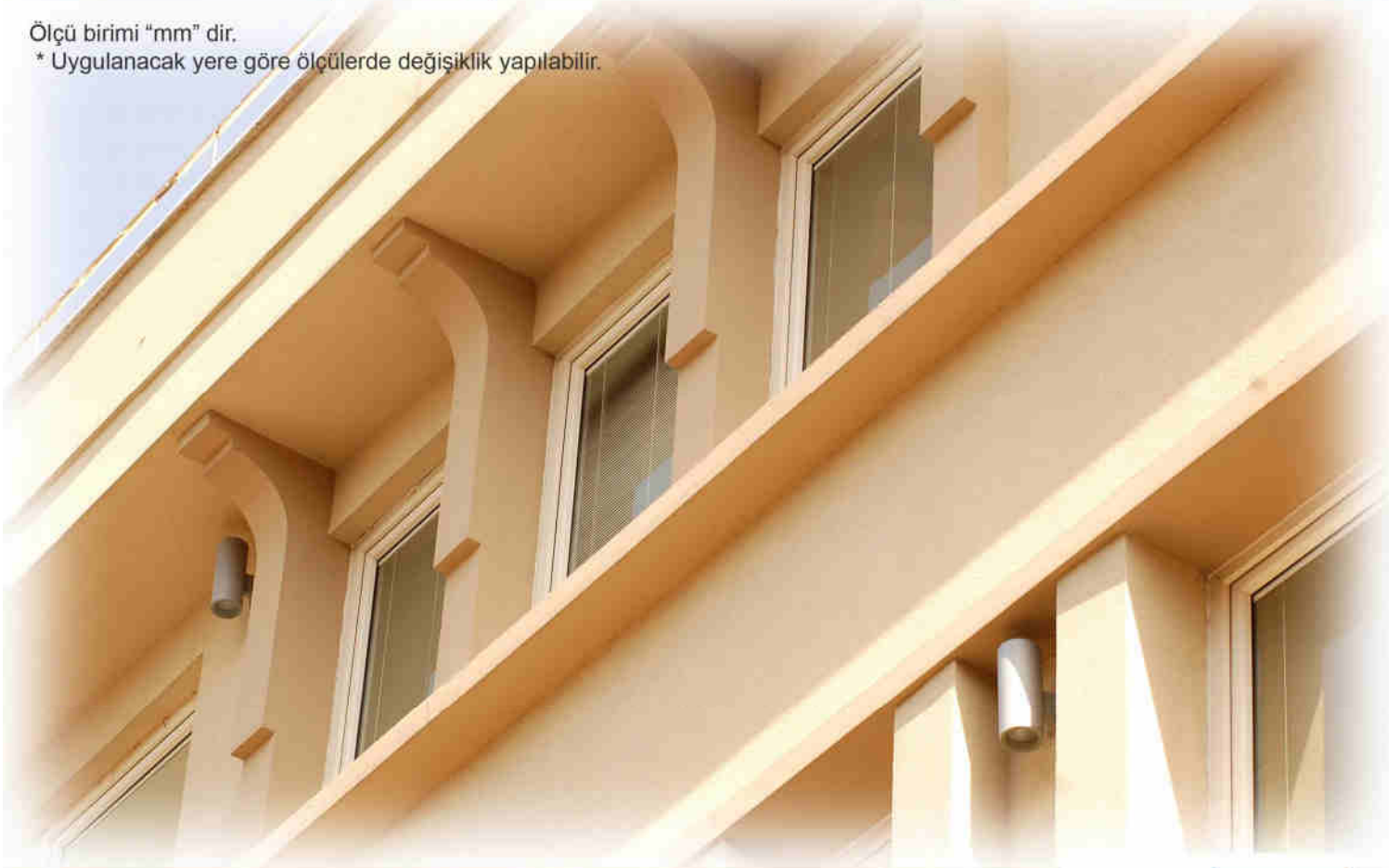

BLUE'S DECOR

SÜTUN VE KAİDELER

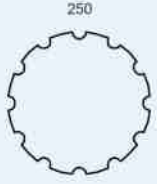

stn-01



stn-02

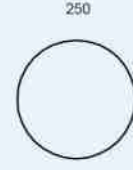

stn-03



kd-01



kd-02

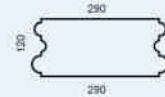

kd-03

Ölçü birimi "mm" dir

sihirli bir dokunuş...

SÜTUN VE KAİDELER

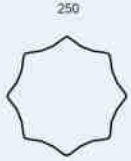

stn-04

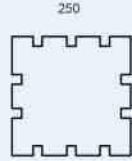

stn-05

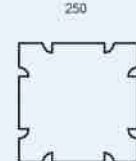

stn-06

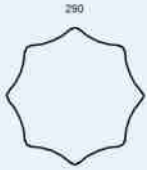

kd-04

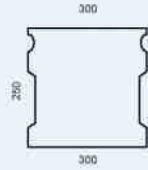

kd-05

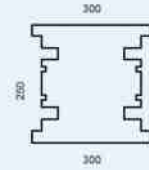

kd-06

Ölçü birimi "mm" dir.



BLUE'S DECOR

DIŞ CEPHE KAPLAMA



tb-01 135x300

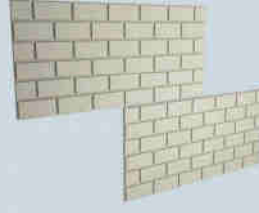

tb-01 85x190

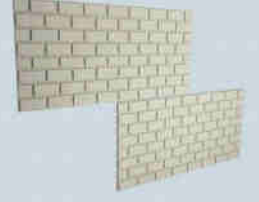

tb-01 60x140

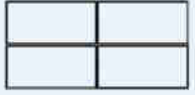

tb-02 285x610

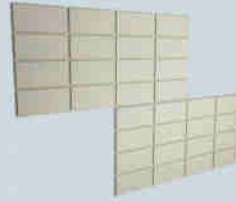
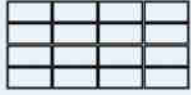

tb-02 135x300

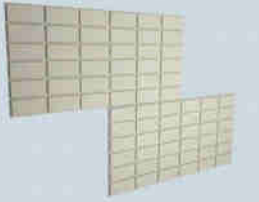
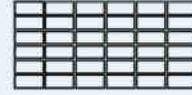

tb-02 85x190

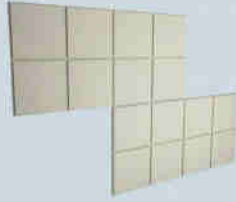
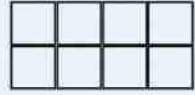

tb-03 285x285

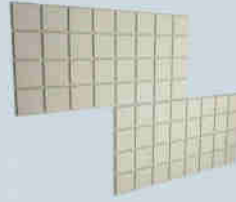

tb-03 135x135



tb-04 s85x190

- * DB ve TB kodlu levhalarının ebatları 600x1250 mm olup kodlardaki ebatlar desen ebatlarıdır. 30-40-50 mm kalınlıklarda üretilebilir.
- * DB ve TB kodlu levhalar dört tarafından binlidir.

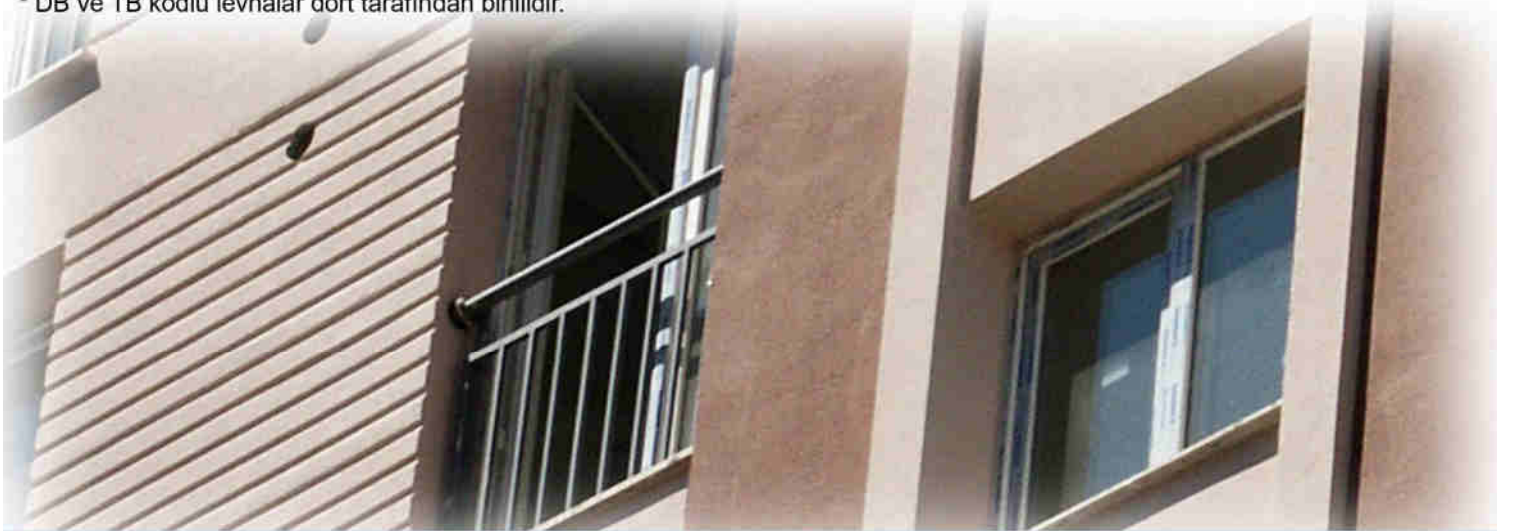

dış cepheniz tecrübeli ellerde...

DIŞ CEPHE KAPLAMA

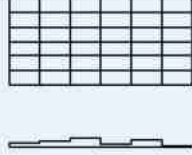
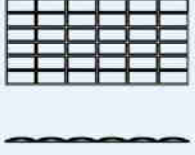

fb-04 85x190

fb-05 100

db-02 300

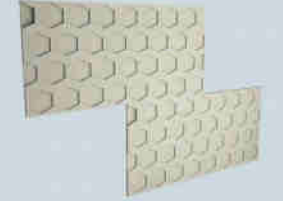

db-02 200

db-03 260

db-03 130



fas-01 600

fas-02 300x600

yb-01

- * DB ve TB kodlu levhalarının ebatları 600x1250 mm olup kodlardaki ebatlar desen ebatlarıdır. 30-40 mm kalınlıklarda üretilebilir.
- * DB ve TB kodlu levhalar dört tarafından binilidir.
- * YB ve FB kodlu levhaların ebatları 590x2000 mm'dir. 30-40 mm kalınlıklarda üretilebilir.



BLUE'S DECOR

DIŞ CEPHE KAPLAMA



y b - 0 2



y b - 0 3



f b - 0 1



f b - 0 2



f b - 0 3



d b - 0 1

* YB kodlu levhaların ebatları 590x2000 mm dir.

* YB, FB, DB 01 kodlu levhalar 30-40 mm kalınlıklarda üretilebilir.



dış cepheniz tecrübeli ellerde...

PENCERE SETLERİ

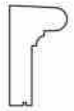

KS20-01



SV10-22



SV15-07



KT07

SET 01



KS30-09



KS15-04



SV10-12



SV10-06

SET 02



SV10-15



SV15-07



KT07

SET 03



SV15-02



DP15-07

SET 04

PENCERE SETLERİ

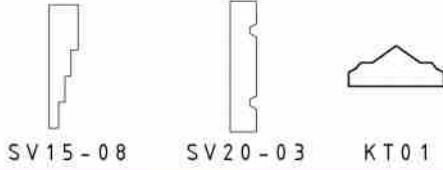

SV15-08

SV20-03

KT01

SET 05



SV10-22

SV10-17

KT04

SET 06



SV10-03

DP15-02

SV15-07

SET 07



DS15-11

DS15-04

DP10-09

SET 08

pencerelerin yeni yüzleri...

PENCERE SETLERİ



SV10-13



DP10-06



KT07

SET 09



SV20-02



SV15-08



KT06

SET 10



KS20-01



KS20-02



DP10-02



KT15

SET 11



DS15



SV10-23



SV15-07

SET 12

KONSEPT TASARIMLAR

1-Saçak Profili	: KS 20-06
2-Ara Silme	: DP 15-04
3-Kolon Çerçeveleri	: SV 10-06
4-Kolon Alt Etekleri	: SV 10-17
5-Kat Alt Etek Profili	: DP 15-02
6-Kat Silme Profili	: KS 20-06
7-Pencere Alın Profili	: DP 10-09
8-Pencere Sütun Başlığı	: KD 05
9-Pencere Sütunu	: STN01
10-Pencere Sütun Kaidesi	: KD 01
11-Denizlik Profili	: DS 15-11
12-Pencere Sövesi	: SV 10-08
13-Pencere Kilit Taşı	: KT 05
14-Denizlik Profili	: DS 15-11
15-Sütun Başlığı	: DP 15-04
16-Payanda	: PY 08

cn classico



1-Saçak Profili	: KS 20-06
2-Kolon Çerçeveleri	: SV 10-03
3-Kolon Alt Etekleri	: KS 15-04
4-Kat Alt Etek Profili	: KS 20-07
5-Kat Silme Profili	: KS 30-07
6-Pencere Alın Profili	: SV 15-07
7-Pencere Sütun Başlığı	: KD 05
8-Pencere Sütunu	: STN01
9-Pencere Sütun Kaidesi	: KD 01
10-Pencere Süslemesi	: KT 07
11-Denizlik Profili	: DS 15-11
12-Pencere Sövesi	: SV 15-07
13-Pencere Kilit Taşı	: KT 07
14-Denizlik Profili	: KS 20-01
15-Pencere Sütun Başlığı	: SV 10-06
16-Pencere Sütunu	: SV 10-22
17-Sütun Başlığı	: DP 15-04
18-Payanda	: PY 10

cn palazzo

dış cephenizin mimarı siz olun...

KONSEPT TASARIMLAR



cn stil

- 1-Saçak Profili : DS 20-01
- 2-Pencere Alın Silmesi : DS 20-01
- 3-Pencere Denizliği : DP 15-02

- 1-Kat ve Saçak Profili : KS 30-05
- 2-Pencere Sövesi : SV 10-09
- 3-Pencere Kilit Taşı : KT 13
- 4-Pencere Altı Kaplaması : FB 01
- 5-Balkon Parapet Altı Pr. : SV 10-18

cn blau



BLUE'S DECOR

KONSEPT TASARIMLAR

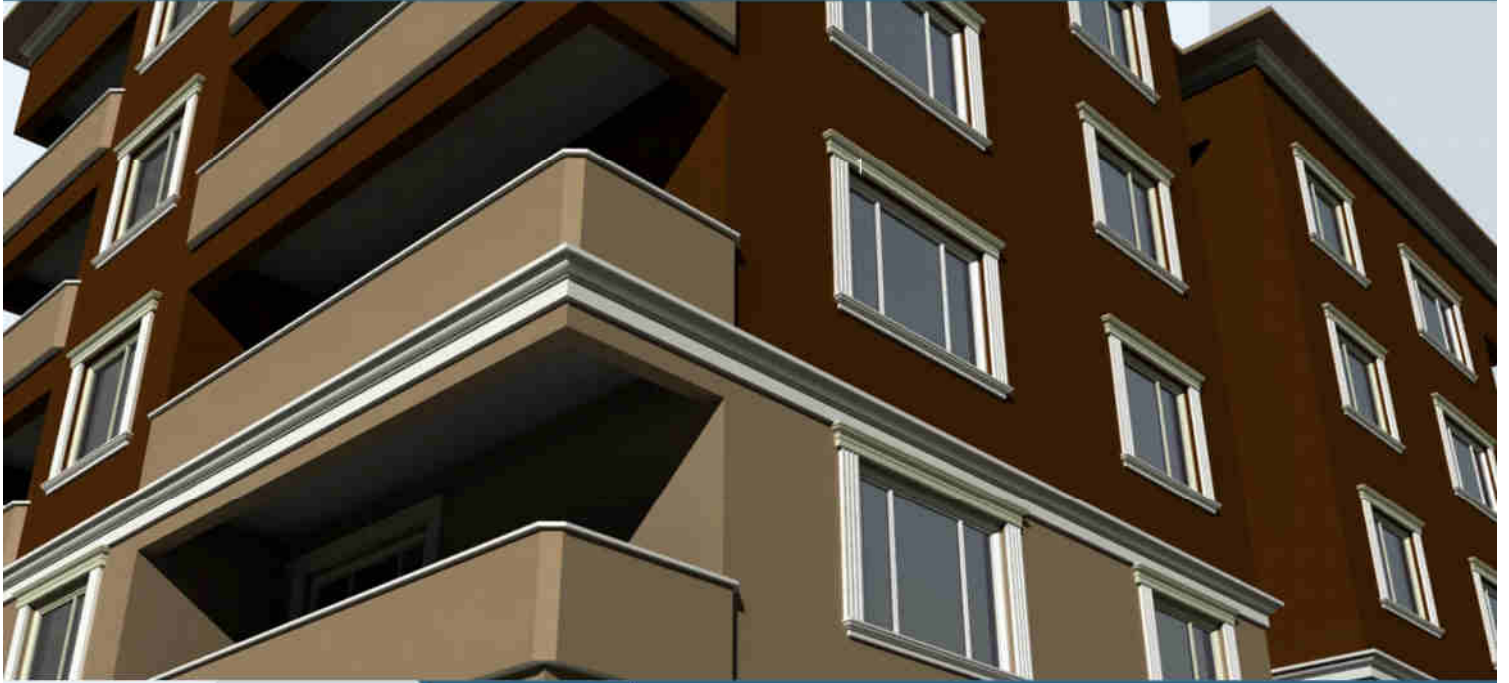

cn ante

1-Saçak Profili	: KS 20-06
2-Payanda	: PY 11
3-Pencere Sövesi	: SV 15-06
4-Pencere Altı Kaplaması	: TB 04-S
5-Pencere Kilit Taşı	: KT 04
6-Pencere Denizliği	: DP 15-06
7-Balkon Parapet Altı Pr.	: DP 15-01

1-Saçak Profili	: KS 30-08
2-Pencere Alın Silmesi	: DS 15-07
3-Pencere Sövesi	: SV 20-02
4-Pencere Denizliği	: DP 10-09

cn stonic

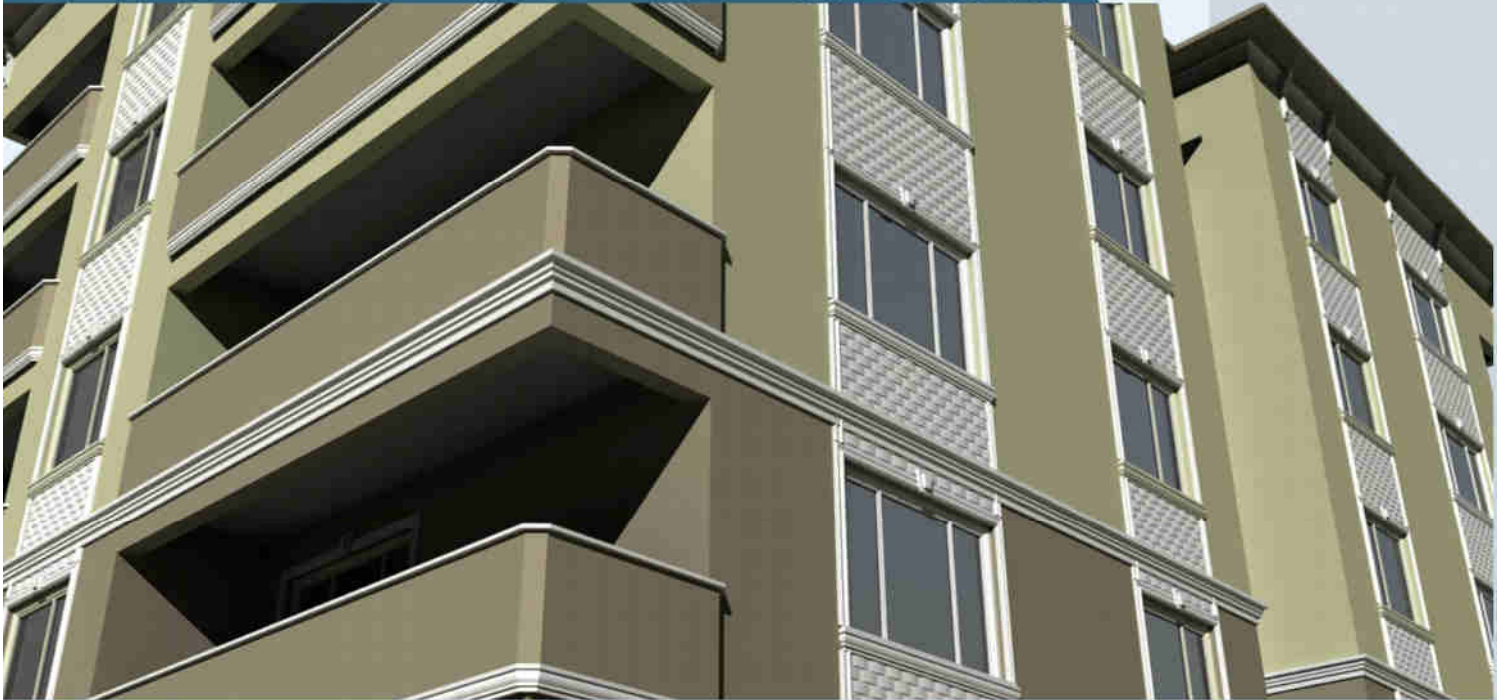

sık cephe



KULLANILACAK MALZEMELER

LEVHA UYGULAMASI



Önce uygulama yüzeyi, şakül, ip, terazi yardımıyla kontrol edilir.



Yapıştırma harcı levhanın arka yüzüne taraklı mala ile uygulanır.



Levha yüzeye yapıştırılır ve yapıştırıcı donana kadar sabitlenir.



Levha ek yerlerine tamir harcı sürülerek yapıştırma sağlanır.



Levha birleşim yerlerinden taşan harç spatula ile temizlenir.



Levha yüzeyi rulo ya da fırça yardımıyla boyanır.

PROFİL UYGULAMASI



Köşe birleşimlerinde gönye yardımıyla kesilecek yer belirlenir ve çizilir.



Profil ya da levha, testereyle işaretlenen yerden kesilir.



Profil üzerine harç noktasal olarak konur ve kenarlardan taşması önlenir.



Profil teraziye alınır ve yüzeye bastırılarak yapıştırılır.



Profil birleşim noktaları tamir harcıyla doldurulup düzeltilir.



Profil yüzeyi rulo ya da fırça yardımıyla boyanır.



KALİTE BİLİNCİ İLE SÜREKLİ TEST



ÇEVREYE DUYARLI ÜRETİM

Çıkan atıklar hammadde dönüşümü için gerekli operasyonlardan geçirilir.

BLUE'S DECOR

www.mavikale.com www.mavikale.com www.mavikale.com www.mavikale.com
www.mavikale.com www.mavikale.com www.mavikale.com www.mavikale.com
www.mavikale.com www.mavikale.com www.mavikale.com www.mavikale.com
www.mavikale.com www.mavikale.com www.mavikale.com www.mavikale.com
www.mavikale.com www.mavikale.com www.mavikale.com www.mavikale.com

BLUE'S DECOR

DOĐRU MANTOLAMA HATTI



0216

444 44 77

www.bluesdecor.com

